

Stereotaxic holder

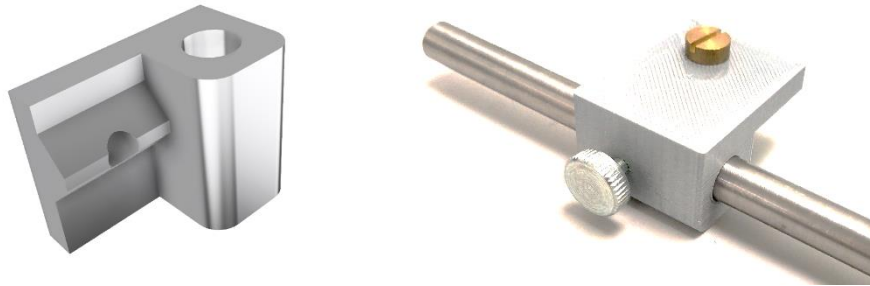

Description

The stereotaxic holder was designed to provide a way to mount equipment (e.g. an injection pipette holder) to a Kopf or Stoelting stereotaxic frame. The holder accommodates 8mm rods which can be secured by an M3 machine screw. The holder is attached to a stereotaxic arm with a machine screw of the appropriate size for the arm (typically 10-32 thread $\frac{3}{4}$ " length).

The stereotaxic holder was designed by Dr Paul Dodson and is distributed under a CC BY-NC-SA (AttributionNonCommercial-ShareAlike) license.



3d printing

The .stl file has been printed on FDM type 3d printers using settings and orientation similar to the following:

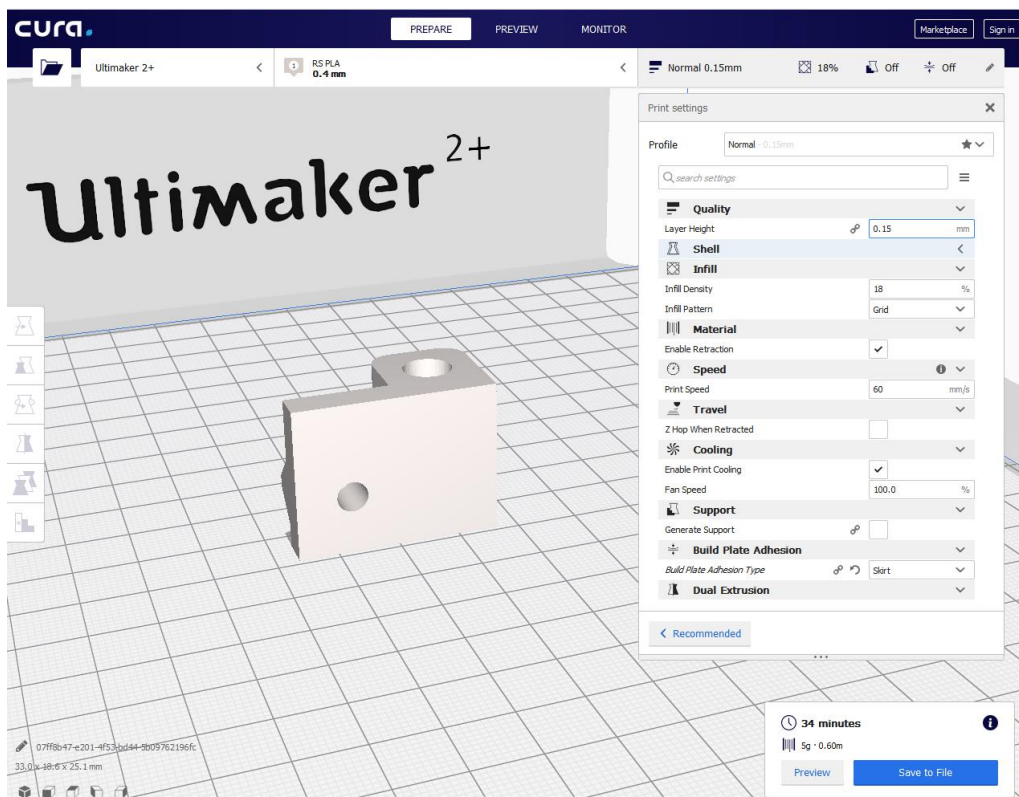

An Autodesk Fusion 360 file (.f3d) is also included with the download